

### SECTION A-A

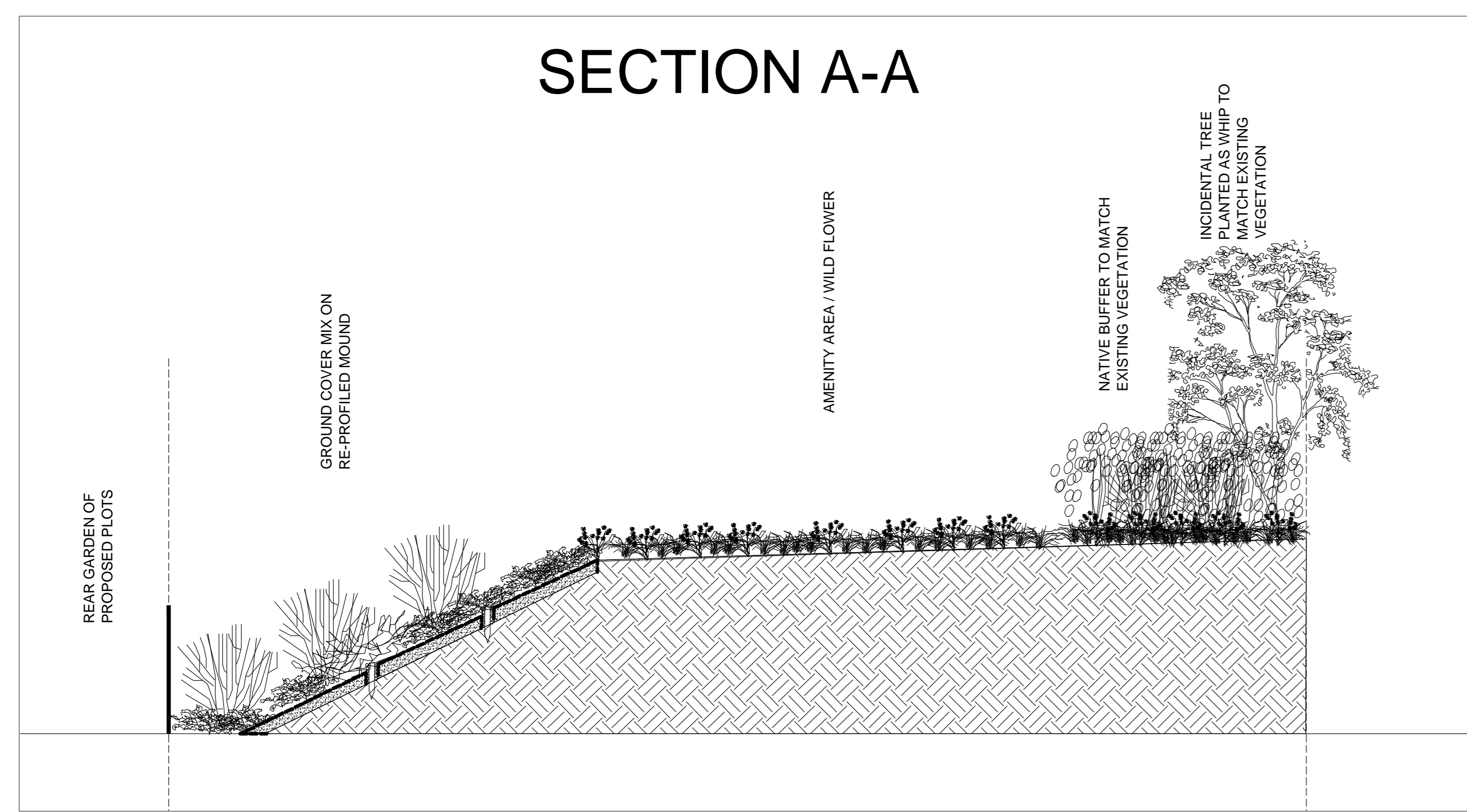

### SECTION B-B

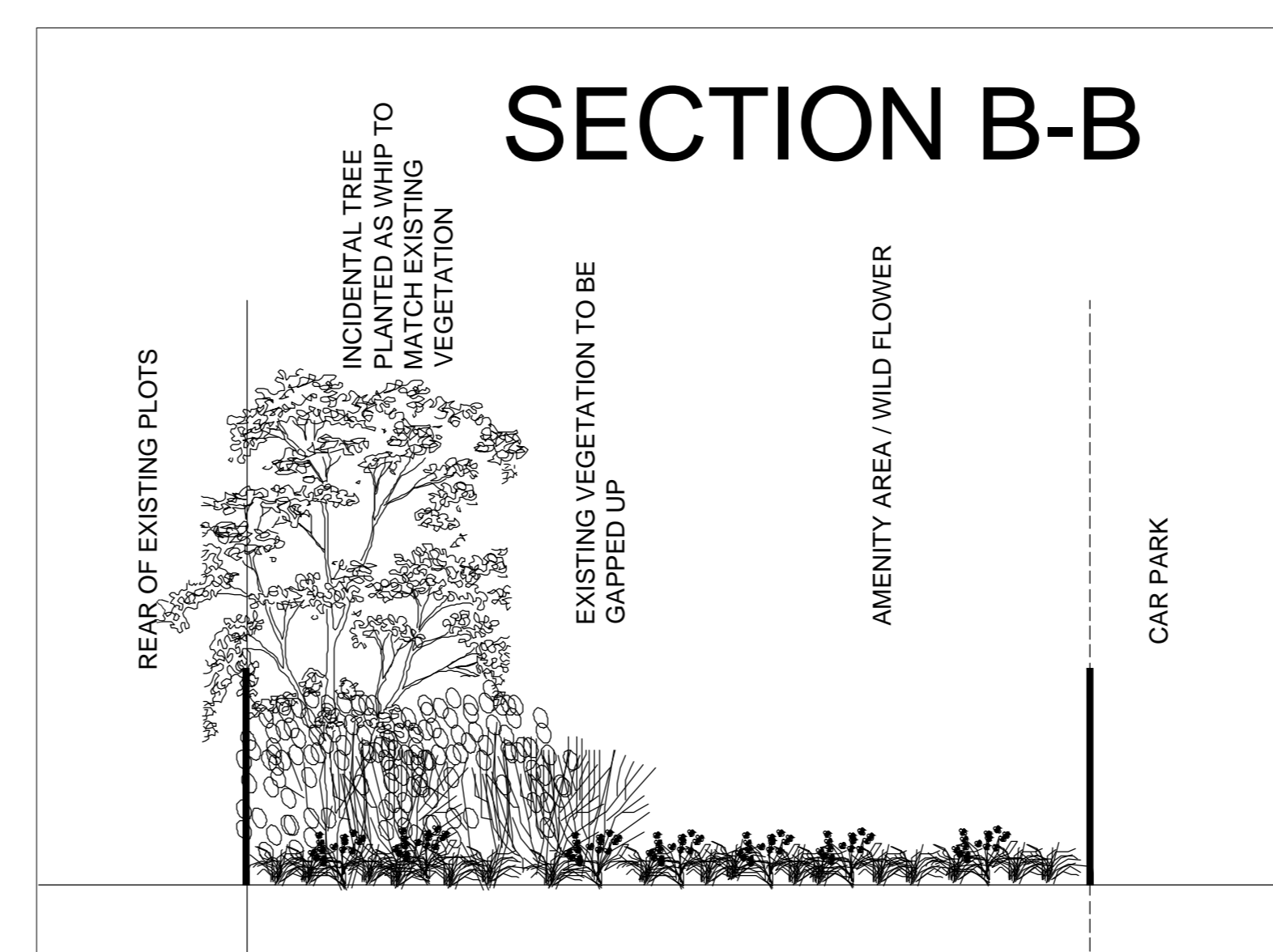

### SECTION C-C

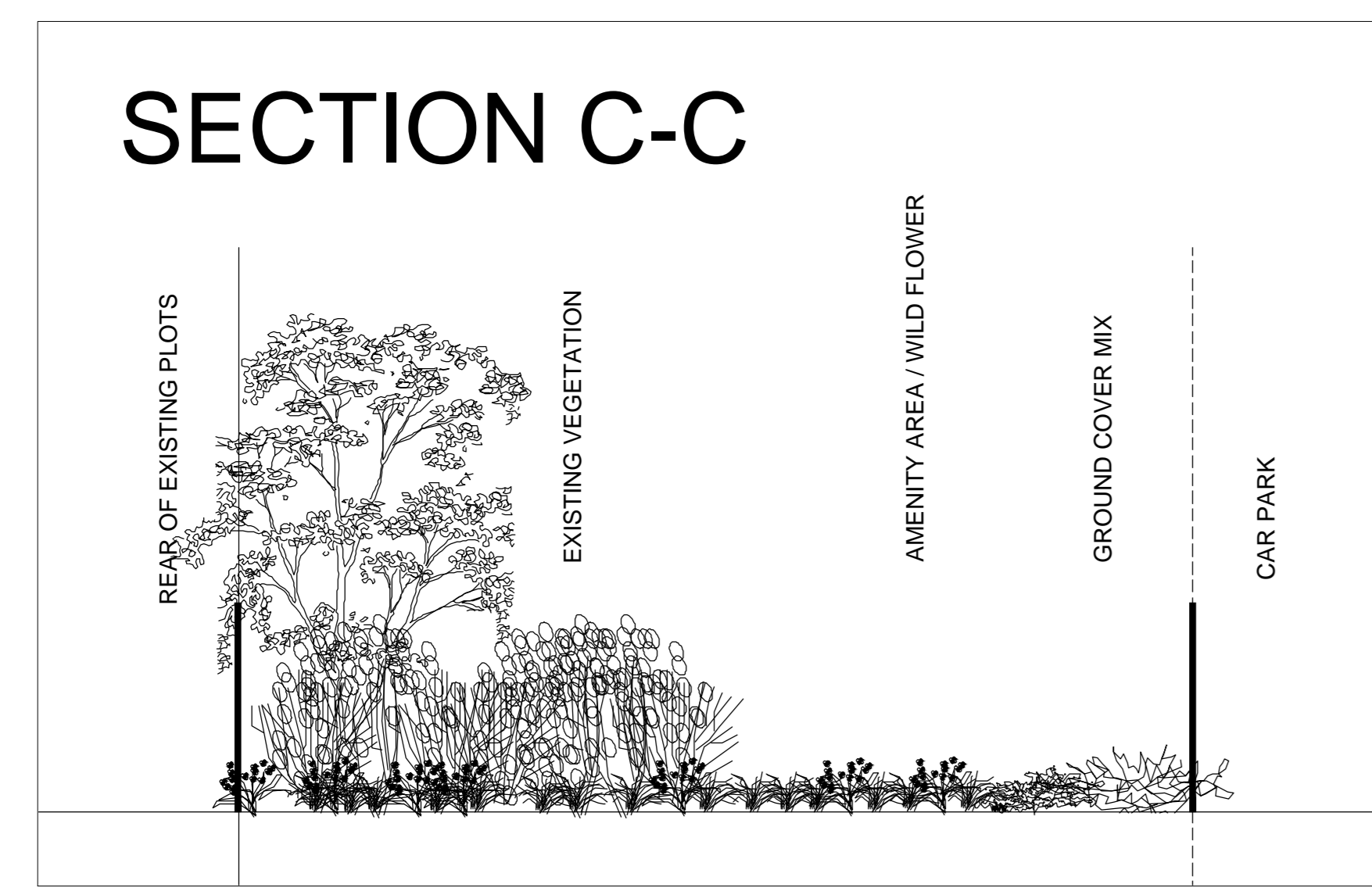

### SECTION D-D

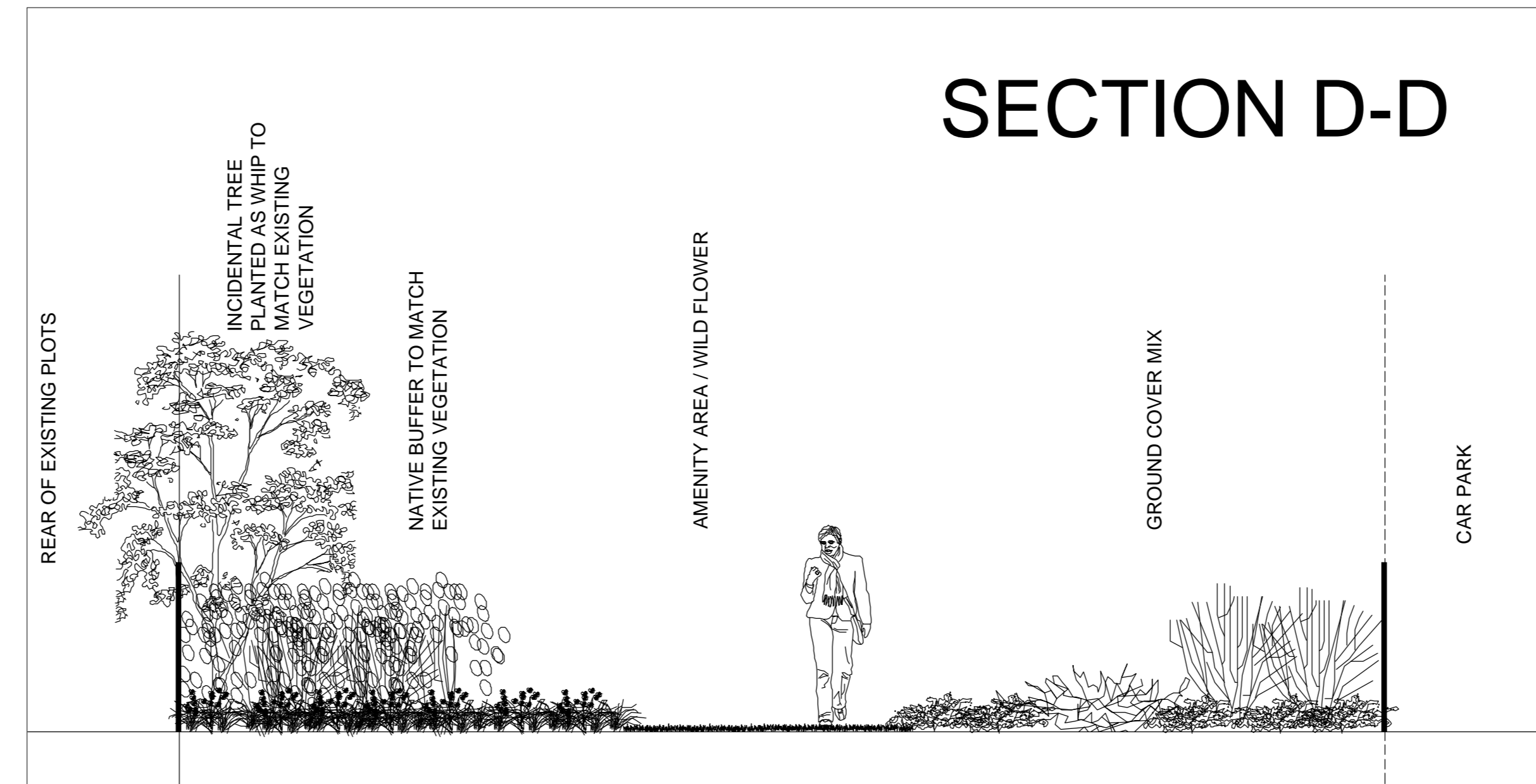

### SECTION E-E

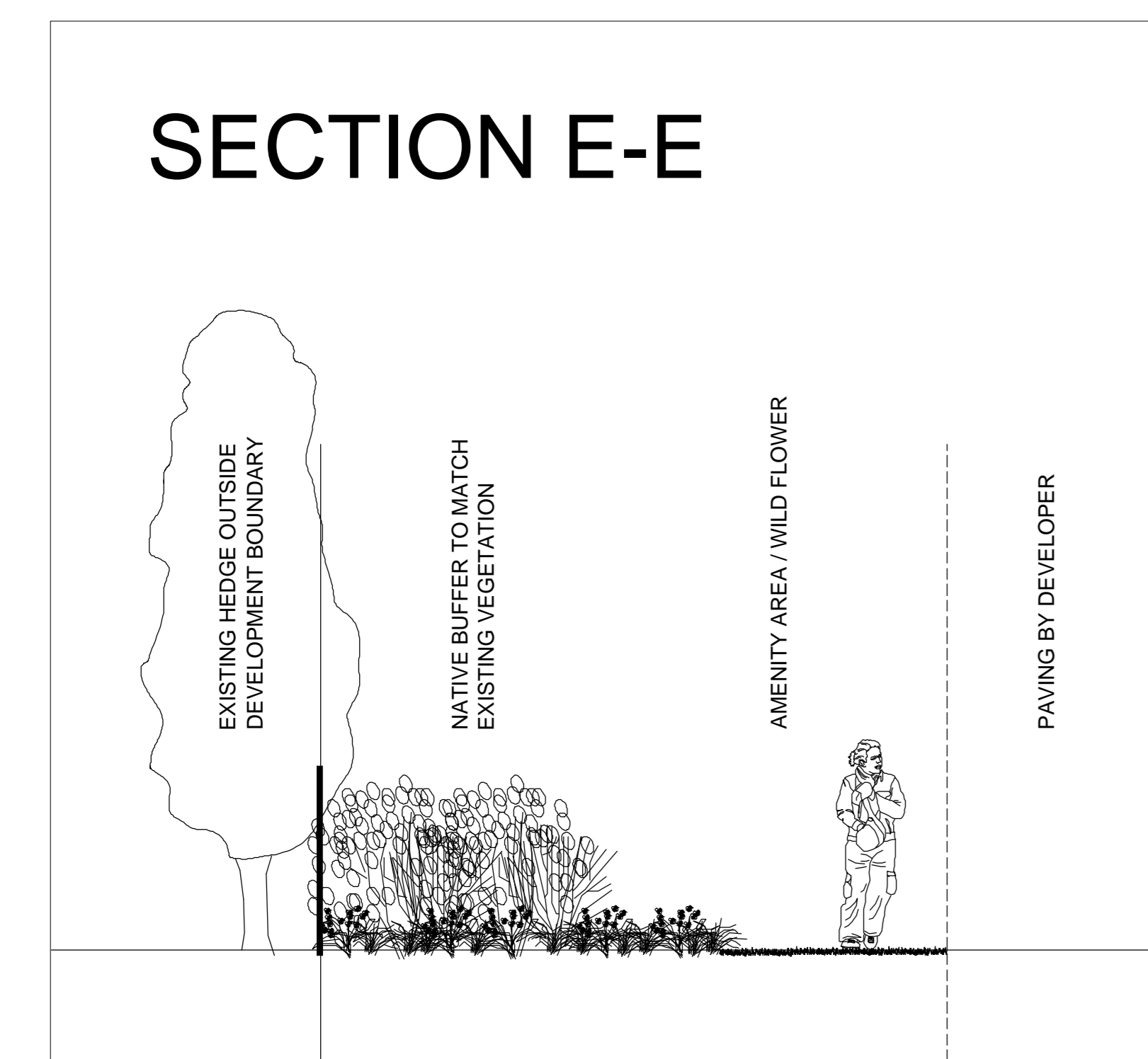

### SECTION F-F

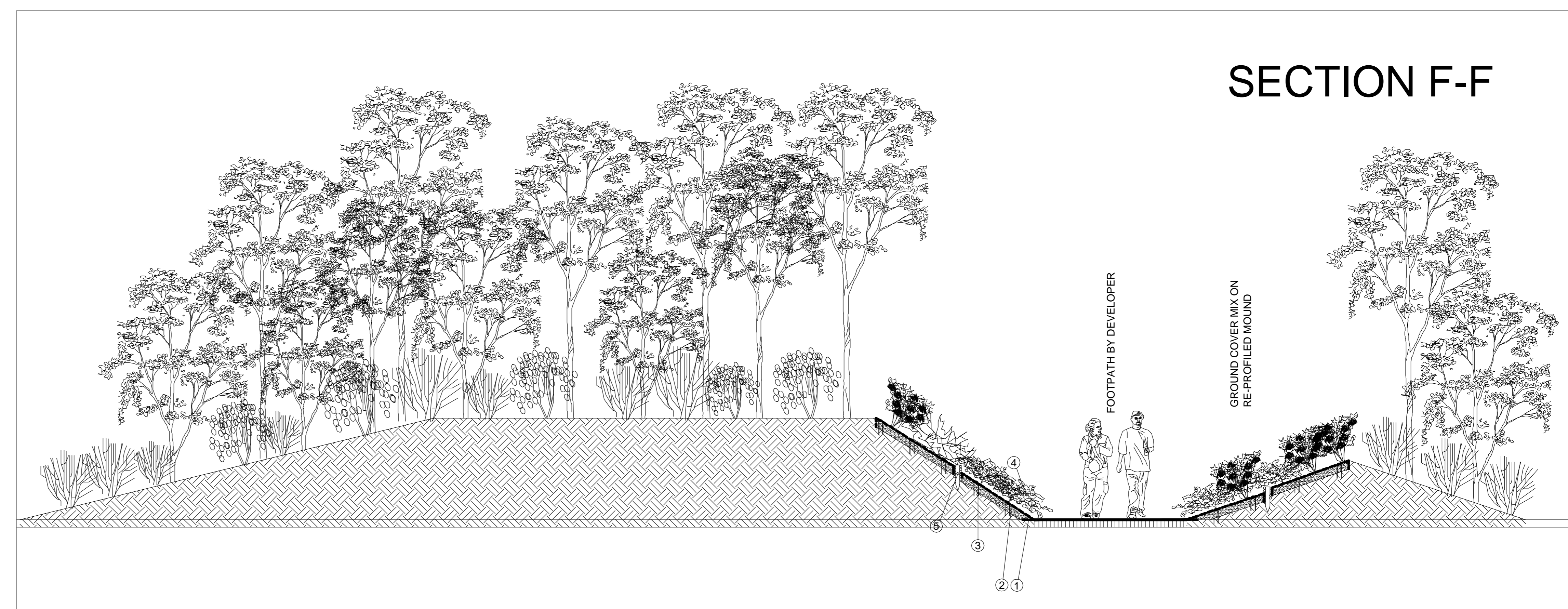

FOR DETAILED SOFT LAYOUT PROPOSALS FOR BUFFER REFER TO DWG JBA 05/20-01

### LOCATION PLAN (NTS)

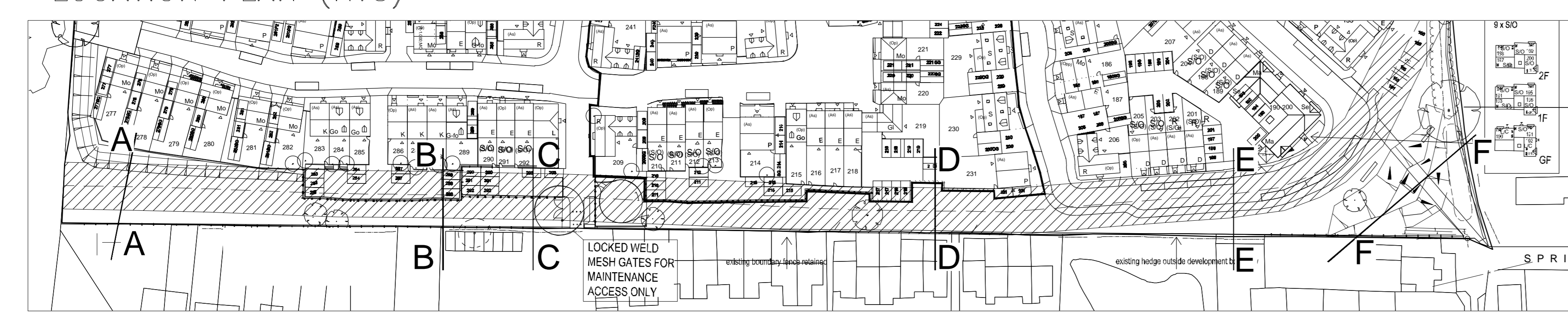

- ABG8F-**
- IMPORTED TOPSOIL TO BE RETIATED TO A DEPTH OF 200mm INCLUDING THAT THE GROUND IS COMPLETELY BROKEN UP AND IS FREE DRAINING. COMPLETE GROUND PREPARATION AS SPECIFIED WITHIN THE REQUIRED WORKS SCHEDULE. INCLUDING PROTECTING SOIL LEVELS AND 60mm BELOW ADJACENT PAVEMENT OR GRASS SURFACES IF SOIL IS DRY, WATER LIBERALLY FROM TO LIVING SHEET MULCH.
  - PERMEABLE BOARD IS A FULLY BIODEGRADABLE NON-WOVEN FABRIC MADE ENTIRELY FROM NON-FIBRES OF SOLUBLE AVAILABLE FROM 'LAST GREEN' UNIT 14 SPRINGFIELD ROAD INDUSTRIAL ESTATE, BURNHAM ON OUSE, LEICESTER ON 0145 270880. UNROLLLED AND PLACED IN OVERLAPPING ROWS. OVERLAP TO BE A MINIMUM OF 200mm TO BE LAPPED BY 500mm. 300mm FLAP OF MATERIAL AT THE EXTREME EDGES OF THE SHEED AREA AND FOLDING OVER ITSELF REFER TO INSET ON WEEDSTOP SPECIFICATION. TUCK IN SHEET ON THE OPPOSITE SIDE OF THE PROPOSED SHEED AREA AND FASTEN CLOSE TO TOEED IN PAIR WITH METAL KEYS OR WOODEN PEGS.
  - METAL KEYS OR 200mm WOODEN PEGS ACCORDING TO GROUND CONDITIONS HAMMERED IN AT 200mm CENTRES TO SECURE SHEETING AVAILABLE FROM 'LAST GREEN' UNIT 14 SPRINGFIELD ROAD INDUSTRIAL ESTATE, BURNHAM ON OUSE, LEICESTER ON 0145 270880. INCREASE FREQUENCY TO 200mm CENTRES AT EDGES TO SECURE SHEET MULCH AT MARKING.
  - SUPPLY AND FIT PLANT STRIGUS THROUGH SHEETING REFER TO FIT PLANTING THROUGH SHEET MULCH SPECIFICATION.
  - WELDED SPILING WARDEN STRUCTURE USING THE ANCIENT TECHNIQUE FOR BUILDING LIVING WILLOW WARDEN. STAKES TO BE CORNUS AVELLANA 45-50mm DIAMETER. WITHIES TO BE CORNUS VIGILANS 20-25mm DIAMETER. LENGTH OF WITHIES SHOULD BE EQUIVALENT TO FIVE TIMES THE STAKE SPACING. TO INSURE TIGHT WEAVE, BUT TO PURCHASE HIGH QUALITY STAKES FROM A RESPONSIBLE SUPPLIER SUCH AS NATURAL FENCING. ALL WEATHERING OR CORROSION APPROVED. WEAVE THE WITHIES BETWEEN THE STAKES, ALTERNATING THE DIRECTION OF THE BUTT JOINTS AND TUCKING BUTT JOINTS IN TO TRY TO NOT PRODUCE AS THE CASE OF CASE LENGTHS OF WITHIES. THE STAKES SHOULD BE RUN JUST BE BOW AND THE BOW TO THE LAST TWO TO THREE STAKES ARE COMPLETELY BURIED AFTER BACKFILLING. TO BETA VARNALS WIRE DOWN THE TOP WITHIES AND SECURE TO THE STAKE WITH A STAPLE.

1 JUL 19	KLC	LOCKED WARDEN GATE AREA TO SOUTH WEST CORNER OF SITE
1 JUL 19	KLC	ADDITIONAL SECTION THROUGH SOUTH WEST CORNER
REV	DATE	REVISION
1	1 JUL 19	INDICATIVE CROSS SECTIONS THROUGH BUFFER AREA
CLIENT		GEORGE WHIMPEY SOUTH MIDLANDS
SITE		STATION ROAD, WOBURN SANDS
DES BY	CHECKED	AUTOCAD
SCALE	DATE	DWG NO.
1:500	MAY 2008	JBA 05/20-01
REV	DATE	BY
1		B

HEAD OFFICE  
The Race Barn, High Road, Levensham, Suffolk, CO19 8DZ  
Tel: 01797 746511 FAX: 01797 742144  
jrom@jrom.co.uk www.jrom.co.uk

**JR**  
LANDSCAPE ARCHITECTURE  
ARBORICULTURE & ECOLOGY